

ANNEX 2: PHOTO IMPRESSION – PICTURES SPEAK

Cow Housing

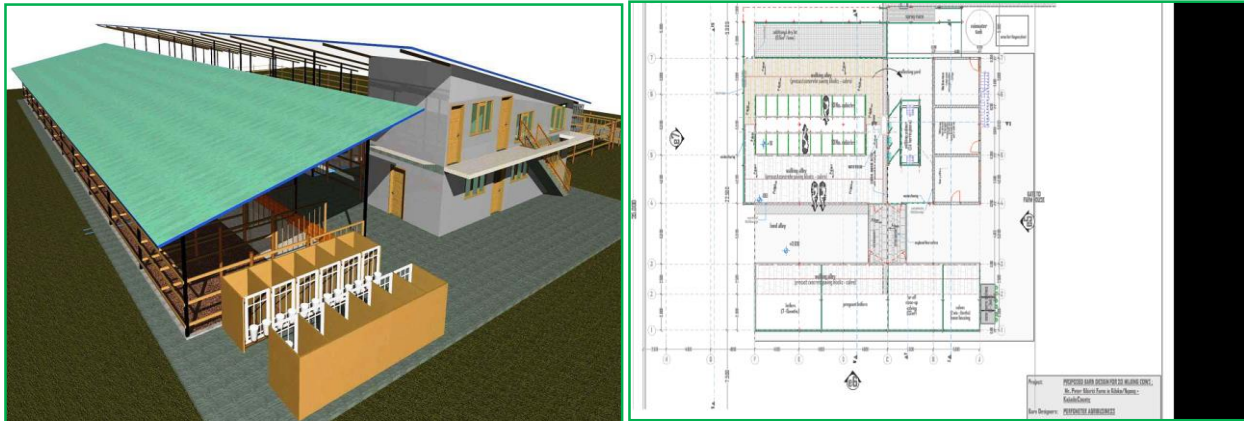

A work-in-progress Cow Barn by one of the MSF's, this was guided by the modular barn design principles. International barn design expert giving inputs for the improvement of the barn (P1,3).



3D and 2D Impressions of the Modular Barn designs. SNV KMDP is supporting MSF with knowledge on cow housing through the development of the modular barn designs and a few pilots

The Service Provider Enterprise Network (SPEN)



Youth during an initial training to become service providers in their respective regions

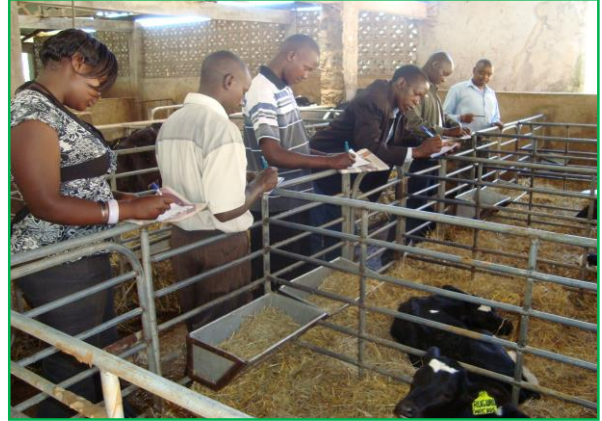

Youth (potential SPEN) during the second phase of training at one of the pilot farms.



SPEN trainees during practicals. The Emphasis of Initial training was Fodder preservation



Experienced SPEN group, sharing experiences with new youthful entrants to Service Provision



The Service Provider Enterprise Network (SPEN) at work: Picture 1& 2: Making silage at different farms for a pay. Picture 3: sensitizing farmers in fodder preservation during a demo, to increase demand for their services. The main service for which SPEN are paid is the silage making

Medium Scale Dairy Farmers Training – EDFA in North Rift and Study Groups in Eastern and Central



PUM Dairy Management Expert Frans Ettema, during practical training on Maize silage at different farms (P1 & 3), and MSF noting down lessons during a study group training in a host farm (P2)



MSF training with PUM expert – (Frans) on the subject of dry matter



MSF training with PUM expert – (Frans) on the subject of milk quality



Medium Scale Farmers training with Halbe from PUM on the use of farm equipment



Some EDFA farmers and Eldosirikwa consultants during training on grass silage

Support for Commercial Fodder Producers through PUM



PUM Agronomist – Jaap De Vrij, during the advisory visits at two different seasons, planting and harvesting. With a farm owner (2) with local consultants from Perfometer in a grass field.



PUM Agronomist – Jaap De Vrij, discusses the subject of weed control with a farmer, and extension personnel in Meru. (2) Jaap interviews a fodder producer about the use of his farm machinery.



Jaap De Vrij (Agronomist from PUM) – Meets one of the maize farmers in North Rift (2) Jaap alongside local Agronomists from Perfometer examine a good Rhodes grass crop in Narok

International Study Tours and Training



Stanley of Eldosirikwa at De Haan Contractors in the Netherlands



David Maina of Perfometer at one of the dairy farms in Netherlands for Total Farm management organized between SNV and PUM



David with Sasha of the Vet Centre (Osterwolde) after farm visits

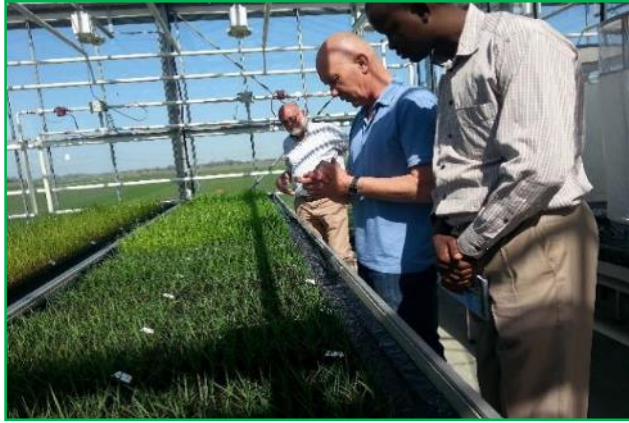

Kenyan Agronomists with Dutch experts during a study tour in the Netherlands. The study tour was organized between SNV and PUM to build their advisory capacity in Fodder Agronomy, Solomon and Ken represented Perfometer and Eldosirikwa respectively. Jaap de Vrij (Agronomy Expert, PUM) was the host for the program



EDFA farmers in an exposure tour to South African Dairy Farms



EDFA farmers in an exposure trips to Netherlands (2014). They were accompanied by their Governor



Farmers from Central, Eastern and North Rift at DTC (Netherlands). During an intro session



Farmers from Central, Eastern and North Rift in Netherlands (2013). Examining a round baler

The Maize Train in North Rift



Checking of the maize harvester ahead of the silage making demo at Selgon



The stage at which the maize was cut for silage



The size of maize chops during the demo



Trucks offloads chopped maize at the designated surface silage bunker



Participants watch as compaction progresses. Weight enhanced tractor was used for this

Cow Signals Training at PDTC's.

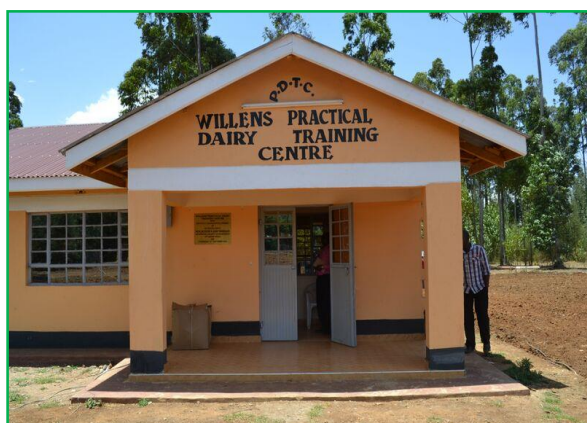

Willens, One of the Practical Dairy Training centres where cow signals training took place. It is situated in one of the dairy farms in Eldoret



Cow Signals trainer, Jan Huslen of Vetvice, takes the participants through a participatory session on Young Stock Management inside the barn



Cow Signals Trainees use a check list as one of the learning and application tools, guided by the Trainer and the Farm owner

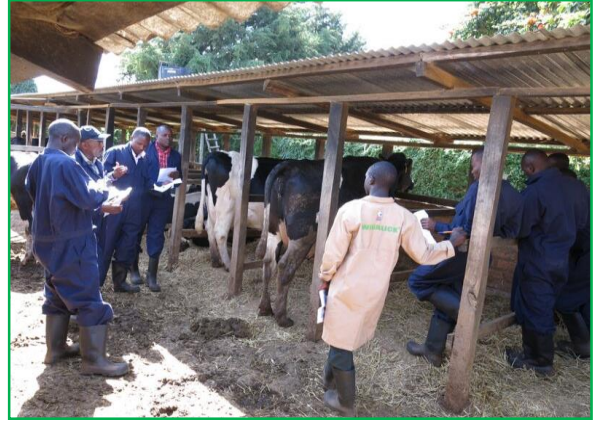

Cow Signals Trainees take a practical session on identification of cow signals among the cows. They were organized in small groups



Participants take a group photo with the Trainers, Jan Hulsen of Vetvice and Wytze (Dairy Management Expert), after being issued with course certificates.



Jelle (MD, Roodbont) Anton (SNV, KMDP), David (Perfometer) and Peter (Olive Publisher). The team is involved in the development of Cow Signals EA edition

Innovation Fund Project at Gogar Farm



Different Parts of the Fodder Processing machine awaiting assembly at Gogar Farm in 2014.



The imported silage compacting equipment at Gogar Farm before assembly in 2014 (P1), the 50 & 70kg packs that were made using the equipment. It was acquired through KMDP's innovation fund